

Rzut lokalu

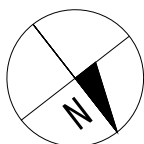
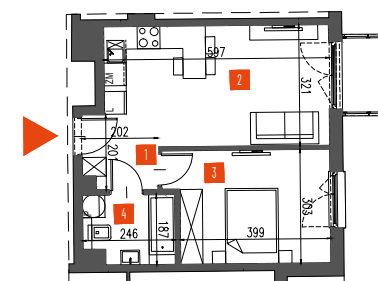

NR	POMIESZCZENIE	POW.
1.	PRZEDPOKÓJ	3,80 m <sup>2</sup>
2.	SALON Z ANEKSEM	17,69 m <sup>2</sup>
3.	POKÓJ	12,36 m <sup>2</sup>
4.	ŁAZIENKA	4,22 m <sup>2</sup>
<b>SUMA:</b>		<b>38,08 m<sup>2</sup></b>
BALKON:		2,69 m <sup>2</sup>